

**UNDER**

**THE COMMISSIONS OF INQUIRY ACT 1908**

**IN THE MATTER OF**

**ROYAL COMMISSION OF INQUIRY INTO  
BUILDING FAILURE CAUSED BY CANTERBURY  
EARTHQUAKES  
KOMIHANA A TE KARAUNA HEI TIROTIRO I  
NGA WHARE I HORO I NGA RUWHENUA O  
WAITAHA**

---

**STATEMENT OF EVIDENCE OF PENELOPE ANN SPENCER  
IN RELATION TO THE CTV BUILDING**

**DATE OF HEARING: COMMENCING 25 JUNE 2012**

---

## **STATEMENT OF PENELOPE SPENCER IN RELATION TO THE CTV BUILDING**

1. My full name is Penelope Ann Spencer. I live in Auckland and am a Communications Consultant.
2. Until 5 March 2012 I had lived in Christchurch all my life. I was a Production Assistant for CTV where I had worked for 2 years.

### **The CTV Building**

3. Until 22 February 2011 CTV was situated on Levels 1 and 2 of the CTV Building (the Building) at 249 Madras Street, Christchurch.
4. I have done a Floor Plan (Plan) of Levels 1 and 2. This Plan is annexed hereto and marked with the reference WIT.SPENCER.0001.5 for Level 1 and WIT.SPENCER.0001.6 for Level 2.

### **Before 22 February 2011**

5. After September 2010 the Building had been issued with a Green Sticker and I am sure it had been checked out by someone else independently, although I never saw anyone around.
6. After the September 2010 earthquake the Building also had several noticeable cracks. On Level 1 there were cracks in the plasterboard on the south wall of the master control room. One crack went diagonally up the wall and was about 50 centimetres long. After Boxing Day this crack went almost the whole length of the wall, about 2 to 2.5 metres in length. This crack also had other cracks leading off it after the Boxing Day earthquake. I have marked the location of this crack with the number "1" on the Plan.
7. There was a significant crack around the internal pillar between the cafeteria and the staff computers on Level 2. Here the carpet along the edge of the internal wall had separated from the pillar by about 1 centimetre. This had previously been attached before the September 2010 earthquake. I have marked the location of this pillar with the number "2" on the Plan.

8. There were cracks on internal walls on Level 2. Cracks on walls along the corridor by the editing room went straight up the wall and were 10 to 20 centimetres long. I am sure these cracks also grew bigger after the Boxing Day 2010 earthquake. I have marked the location of these cracks with the number "3" on the Plan. I am sure there were also cracks around windows and door frames but I do not recall where they were. I think windows may have been broken along the east wall of Level 2 too.
9. I never saw any cracking on the outside of the Building.
10. I do not think anyone at CTV felt safe in the Building. Sometimes we would joke around and jump into the cafeteria on Level 2 which would make the floor shake. The floor also shook every time someone walked down the corridor on Level 2. This did not happen prior to the September 2011 earthquake.

### **Building Demolition**

11. During the demolition of the building next door in January 2011 the Building constantly shook. It felt like we were having aftershocks all day but it was just the Building shaking.

### **22 February 2011**

12. On 22 February 2011 I was walking back to the Building on my lunch break with my boyfriend, Tom Hawker (Tom). We had just been to the dairy on the south side of Cashel Street opposite Les Mills. We were walking back across the road, almost in line with the Building car park entrance to the south of the Building and in line with the west wall when the earthquake struck. I could see the whole south side and the southern end of the west side of the Building. Where I was standing on Cashel Street is marked with the number "4" on the Plan.
13. The Building was swaying back and forth, in a north and south direction. After about 10 seconds it started to collapse. All the glass on every floor on the south side shattered. The concrete pillars then exploded on the 4<sup>th</sup> Floor (Level 5). The pillars I could see on the south side collapsed at the same time. I was focused on the south side of the Building so I did not see what happened on the west side of the Building.

14. Level 5 then collapsed down and hit the next floor down. It stopped for about half a second and then it dropped again onto the next floor down. The Building then pancaked all the way down to the ground. The top floor (Level 6) dropped as a unit, staying intact until it hit the rubble at the bottom.
15. After the collapse, water pipes from the top levels had sheared off at the North Core and were leaking out a significant amount of water onto the rubble below. A fire started at the northern end of the Building almost immediately after the collapse.
16. The Building had come down so straight that Tom's car, which was parked in the second car parking space closest to Madras Street and along the South Wall of the Building, really only had the bumper knocked off it and the windscreen smashed. I have marked the location of Tom's car with the number "5" on the Plan.

Signed:   
Penelope Spencer

Date: 14<sup>th</sup> May 2012

# CTV BUILDING LEVEL 1 (GROUND FLOOR)

CASHIEL STREET

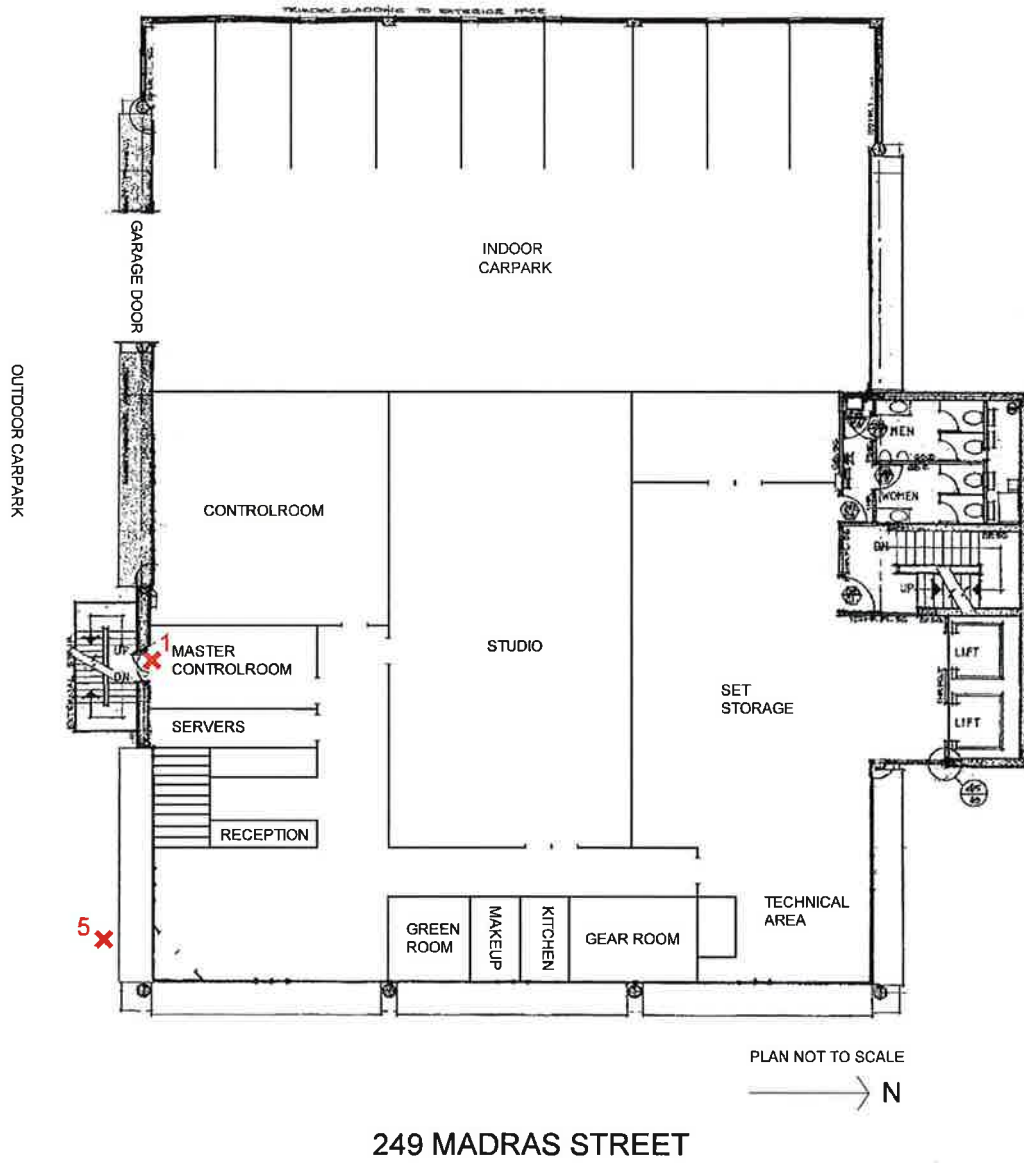

## KEY

1. Cracking on the wall in the master control room
2. Cracking on internal pillar
3. Cracking on internal corridor walls
4. Location at the time of the earthquake
5. Location of Tom's car in the CTV carpark

# CTV BUILDING LEVEL 2

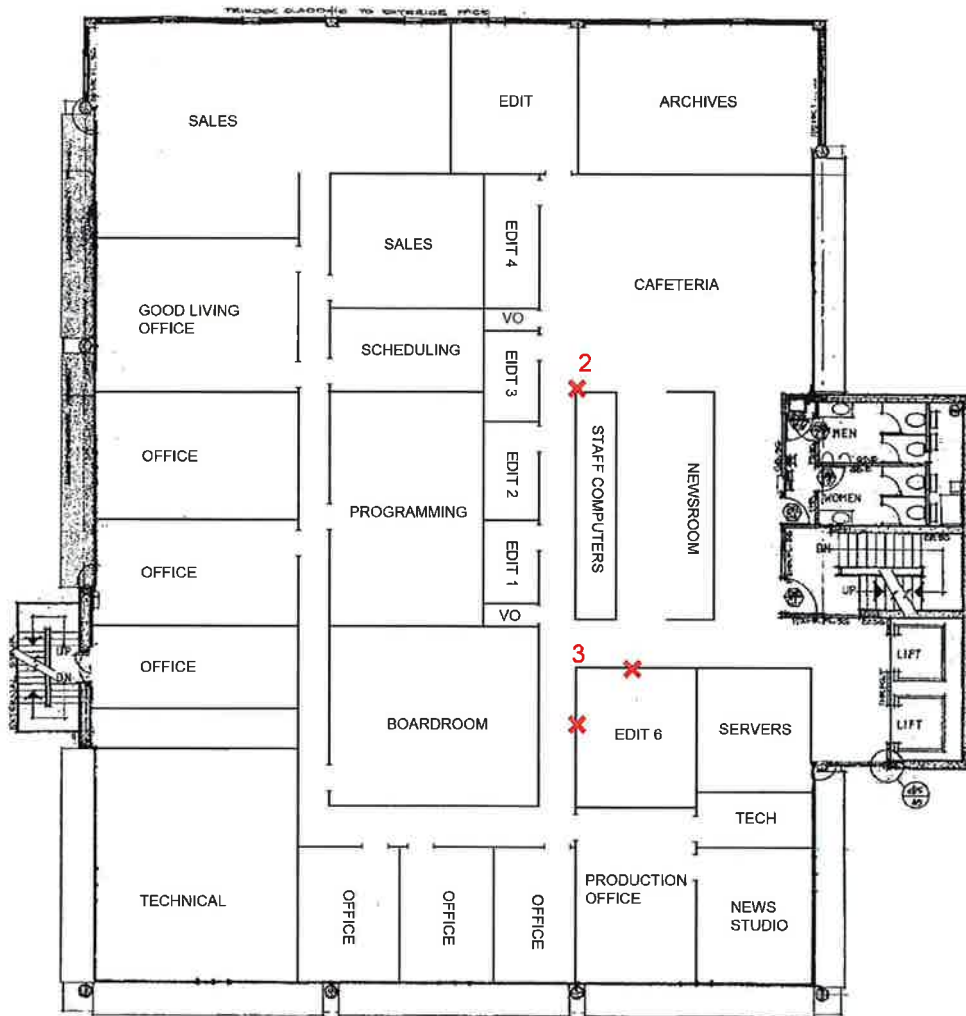

PLAN NOT TO SCALE



249 MADRAS STREET



